

EXAMPLE OF SWIMMING
POOL PLACEMENT (LEFT REAR)

SCHEDULE 1133.08(a)(1)

MINIMUM SETBACKS: FRONT LOT LINE N/A
MINIMUM SETBACKS: SIDE LOT LINE 10'
MINIMUM SETBACKS: REAR LOT LINE 10'

SCHEDULE 1133.08(b)

MAXIMUM REAR YARD COVERAGE OF ALL
ACCESSORY BUILDINGS AND STRUCTURES,
INCLUDING DECKS, PAVEMENT, PATIOS
AND POOLS IS 60%

ALL SWIMMING POOLS, TOGETHER WITH
ADJACENT WALKWAYS, SHALL BE ENCLOSED
BY A WALL OR FENCE HAVING A MINIMUM
HEIGHT OF 5'

FOR ABOVEGROUND POOLS, THE HEIGHT OF
THE POOL, FROM THE SURROUNDING GRADE
TO THE TOP OF THE POOL WALL, MAY BE USED
AS CREDIT TO MEET THE MINIMUM 5' HEIGHT
REQUIREMENT

ALL FENCES AND OTHER POOL ENCLOSURES
SHALL BE CONSTRUCTED SO AS TO HAVE
NO OPENINGS, HOLES, OR GAPS LARGER THAN 3"
IN WIDTH, EXCEPT FOR DOORS, GATES OR
WINDOWS WHICH SHALL BE EQUIPPED WITH
SUITABLE LOCKING DEVICES TO PREVENT
UNAUTHORIZED ACCESS. ACCESS SECURED
ACCESSORY BUILDINGS AND WALLS OF
PRINCIPAL BUILDINGS MAY BE USED IN PLACE OF,
OR PART OF, THE ENCLOSURE
A LIVING FENCE SHALL MEET THE REQUIREMENTS
FOR AN ENCLOSURE WHEN THE PLANTS ARE
CLOSELY SPACED SO AS TO PREVENT UNAUTHORIZED
ACCESS TO THE POOL AREA
THE CONSTRUCTION AND OPERATION OF THE POOL
SHALL MEET ALL OTHER CITY REGULATIONS

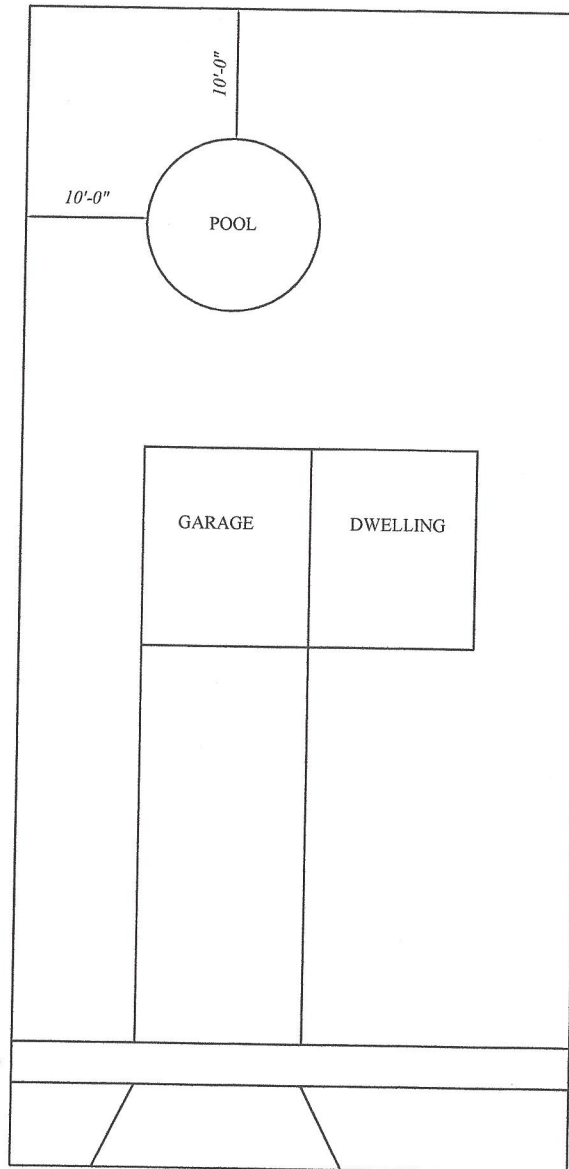

PLEASE PROVIDE FENCE
APPLICATION

PLEASE PROVIDE
ELECTRICAL APPLICATION

PLEASE PROVIDE
HVAC APPLICATION
(POOL HEATER)
(IF APPLICABLE)